

Jansen Transport casters (set) for MB-300 und MB-360°

Transport casters (set) for mini excavator

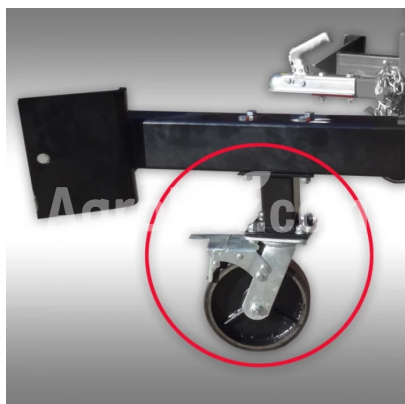

Description

The transport casters for the mini excavator MB-300 und MB-360° can simply be screwed on to the support legs, the holes for this have already been drilled.

By turning the support legs through 90°, one can easily change from the support Position into the transport Position. This feature allows to move the mini excavator conveniently for short distances, e.g. to the storage room.

Company seat

Agrohof Kft.
6064 Tiszaug, Bokros tanya 16.

Sales

+34 667 954 677
info@agrohof.com

<https://agrohof.com/sku/j33-10318>

